

AIPARF

4" Decorative Aluminum Poles

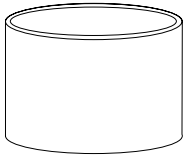

4" Round



3" Tenon



AIPARF416AB: 16 Feet
AIPARF422DB: 22 Feet

The Atlantic AIPARF Decorative Round Aluminum poles are built from extruded fluted 11 Gauge aluminum tubing and are offered as direct burial or with a high-strength die cast aluminum base. A pole top plate with a 3" vertical tenon is provided. Typical area lighting applications include retail centers, industrial parks, schools and universities, parks and pedestrian pathways and gathering spaces. Mounting heights to 16 feet can be used based on selected luminaire application.

Specifications and Features:

Pole Specifications:

The Pole Shaft is One-Piece Extruded Fluted .120 (11 Gauge) Aluminum with a 4" O.D. in Direct Burial and Anchor Base Styles. The Anchor Base is Die Cast Aluminum Welded to the Shaft.

Finish:

Textured Architectural Black Powdercoat Finish, Baked to Ensure Maximum Paint Adhesion, Hardness and Durability.

Anchor Bolts:

Set of Four 3/4" x 18" Anchor Bolts are Included.

Hand Hole:

2 1/4" Diameter Hand Hole with Gasketed Cover with Stainless Steel Bolt.

Base Cover

Optional Square Formed and Riveted Aluminum Cover or Decorative Two-Piece Wrap-Around Cast Aluminum Base Available (Sold Separately)

Mounting:

Includes Removable 3" Aluminum Reducing Tenon with Black Powdercoat Finish and Stainless Steel Hardware.

Order Information Example:

AIPARF422DBBLAB

AIPARF		B	
Model	Shaft/Height/Style	Color	Options
AIPARF= Fluted Aluminum Extruded Pole	416AB=16' Anchor Base Pole 422DB=22' Direct Burial Pole	B=Black	(Leave Blank)=No Options LAB=Less Anchor Bolts (2)

Project Information:

Project Name: _____ Fixture Type: _____

Complete Catalog #: _____ Date: _____

Comments: _____

Notes:

1. All poles include anchor bolts standard.
2. Poles can be cut to custom lengths. Consult factory.



Wind Loading and Dimensional Data:

Pole Description		80 MPH	90 MPH	100 MPH	110 MPH	120 MPH	130 MPH	140 MPH	150 MPH	160 MPH	170 MPH	180 MPH	200 MPH
Shaft Size & Wall Thickness	Mounting Height	Max EPA (SQ FT)	Max EPA (SQ FT)	Max EPA (SQ FT)	Max EPA (SQ FT)	Max EPA (SQ FT)	Max EPA (SQ FT)	Max EPA (SQ FT)	Max EPA (SQ FT)	Max EPA (SQ FT)	Max EPA (SQ FT)	Max EPA (SQ FT)	Max EPA (SQ FT)
AIPARF	12'	24.20	19.20	14.80	11.80	10.95	9.06	7.58	6.37	5.38	4.57	3.88	0.65
	14'	19.40	15.40	11.60	9.20	8.61	7.02	5.78	4.76	3.93	3.25	2.67	-
	16'	15.00	12.00	8.90	6.93	6.64	5.31	4.27	3.41	2.70	2.14	1.64	-

NOTES:

1. Maximum EPA (Effective Projected Area) based on "C" Exposure.
2. EPAs are approximate, specific to location and local codes. Consult engineer for specific application.
3. Allowable EPA Weight Load (LBS): To determine maximum pole loading weight, multiply allowable EPA by 30 LBS.
Example: AIPARF 16' pole in 120 mph zone = 199.2 LBS (6.64 x 30)
4. Variations from sizes above are available upon inquiry at the factory.
5. Satisfactory performance of poles is dependent upon the pole being properly attached to a supporting foundation of adequate design.

Pole Data:

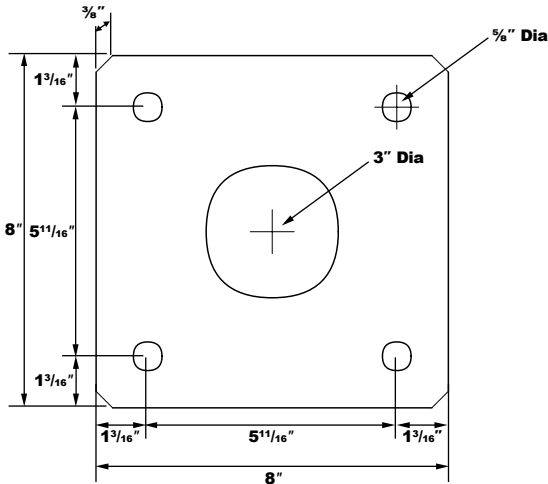

Shaft Base Size	Bolt Circle A	Base Size B	Base Thickness C	Anchor Bolt Size
AIPARF4	8" (203mm)	8" (203mm)	3/4" (19mm)	5/8" x 18"

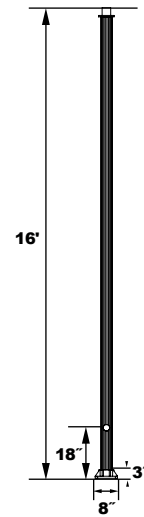

AIPARF416ABB

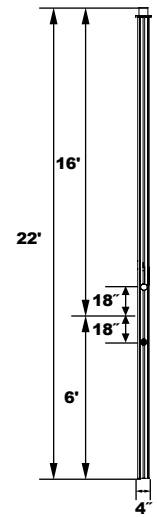

AIPARF422DBB

4" Decorative Aluminum Pole Mounting Options (Order separately, field installed.)

Dual Mounting Arm: Black Finish, Accepts 3" Diameter Fitters, Fits 3" Tenon

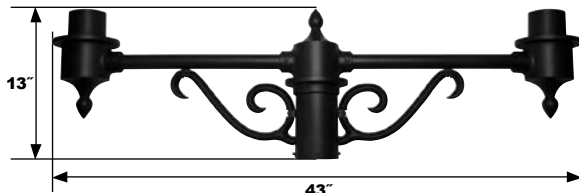

Dual Head Decorative Pole Arm
AIPADAB

Wall Mounting Bracket: Black Finish, Accepts 3" Diameter Fitters

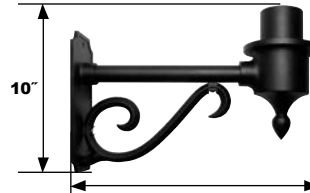

Single Decorative Wall Mount Bracket
AIPWASAB

Bases:

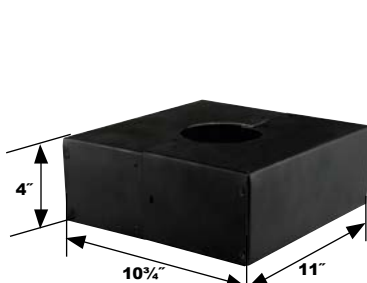

AIPARF4BCB



AIPB24A4B

Replacement Parts (Order Separately, Field Installed)

- AIPARF4BCB Square Cover for 4" Pole, Black Finish
- AIPB24A4B Two-Piece Base for 4" Pole, Black Finish