

Round & Square Low Profile Pathway Bollards



AINB1C3 - Round Low Profile Pathway Bollard



AINB2C3 - Square Low Profile Pathway Bollard

L70
25°C **106,000 Hours**

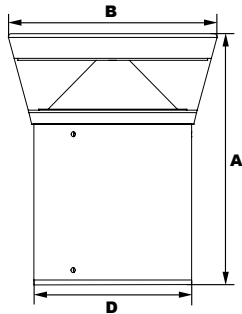

Dimensions	
Width (B)	9 1/4" (234mm)
Diameter (D)	7" (180mm)
Height (A)	10" (254mm)

The Atlantic AINB1C3 and AINB2C3 LED Low Profile Pathway Bollards with UV-stabilized polycarbonate lenses and sealed optical compartments are designed to replace incandescent and halogen pathway lighting. These fixtures are ideal for retail centers, parks, schools and universities, public transit and airports, office buildings and medical facilities.

Specifications and Features:

Housing:

Extruded Aluminum Housing with Flush Mounting Base & Vandal-Resistant Screws, Flat Top, Internal Driver Tray for Easy Maintenance.

Listing & Ratings:

CSA: Listed for Wet Locations, ANSI/UL 1598, 8750
IP66 Sealed LED Compartment.

Finish:

Textured Architectural Bronze or Black Powdercoat Finish Over a Chromate Conversion Coating. Custom Colors Available Upon Request.

Reflector:

Reflective White UV-Stabilized Polycarbonate Cone Reflector

Lens:

Clear UV-Stabilized Polycarbonate Vandal-Resistant Lens

Mounting Options:

Mounting Kit with 8" Anchor Bolts, Included.

COB LED:

Cool Copper COB

Wattage:

COB: 20w, System: 20w; (70w HID Equivalent)

Driver:

Electronic Driver, 120-277V, 50/60Hz or 347V, 50/60Hz; Less Than 20% THD and PF>0.90. Standard Internal Surge Protection 2kV. 0-10V Dimming Standard for a Dimming Range of 100% to 10%; Dimming Source Current is 150 Microamps.

Warranty:

5-Year Warranty for -20°C to +40°C Environment.

See Page 2 for Projected Lumen Maintenance Table.

Order Information Example:

AINB1C34X5U41KZ10SF

Model	Wattage	Driver	CCT	Color	Height	Options
AINB1C3 =Round Low Profile Pathway Bollard AINB2C3 =Square Low Profile Pathway Bollard	4X5 =20w	U =120-277V C =347V	41K =4100K	Z =Bronze B =Black C =Custom (Consult Factory)	10 =10" C =Custom*	SF =Single Fuse (120-277V Only) DF =Double Fuse (120-277V Only) SP =Surge Protection

Project Information:

Project Name: _____ Fixture Type: _____
 Complete Catalog #: _____ Date: _____
 Comments: _____

Certification & Listings:



Specifications subject to change without notice. Rev. 021320

Accessories & Replacement Parts:

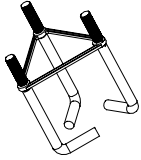

AIBOLAN

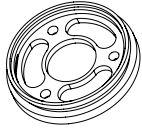

AIBORBASE

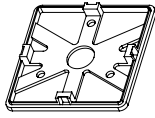

AIBOSBASE

Mounting Accessories (Order Separately, Field Installed)

AIBOLAN4	Mounting Kit, Includes Bracket & Three (3) 4" Anchor Bolts
AIBOLAN8	Mounting Kit, Includes Bracket & Three (3) 8" Anchor Bolts
AIBOLAN12	Mounting Kit, Includes Bracket & Three (3) 12" Anchor Bolts
AIBOLAN15	Mounting Kit, Includes Bracket & Three (3) 15" Anchor Bolts

Replacement Parts (Order Separately, Field Installed)

AIBORBASE*	Die Cast Base Plate with Powdercoat Finish Over a Chromate Conversion Coating. Fits AINB1.
AIBOSBASE*	Die Cast Base Plate with Powdercoat Finish Over a Chromate Conversion Coating. Fits AINB2.

*Specify Color: Z=Bronze, B=Black

Photometric Data

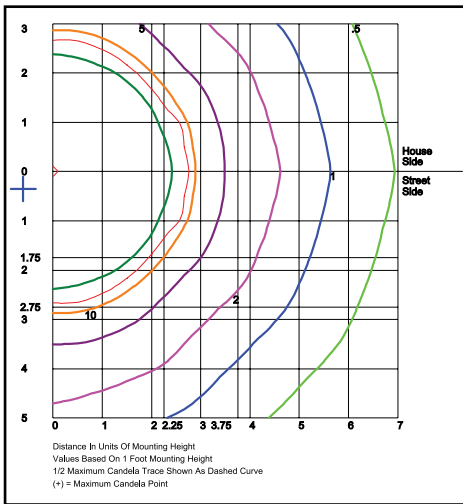

AINB1C34X5U41K
Grid in feet, Mounting Height=1ft.

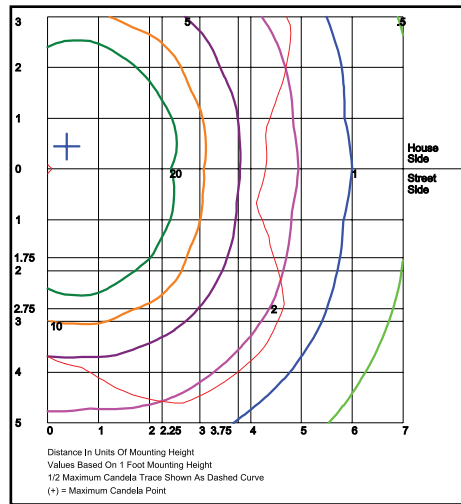

AINB2C34X5U41K
Grid in feet, Mounting Height=1ft.

Photometric Performance

LED COB Watts	Drive Current (mA)	Input Watts	Bollards	4100 CCT 80 CRI				
				Lumens	LPW	B	U	G
COB LED 20w	350	20	AINB1C3 (Round Low Profile Pathway Bollards)	2,282	87	1	0	1
			AINB2C3 (Square Low Profile Pathway Bollards)	2,409	91	1	0	1

Projected Lumen Maintenance

Data shown for 4100 CCT TM-21-11	Input Watts	Compare to MH					Calculated L70@ 25°C
		Initial	25,000 Hrs	50,000 Hrs	100,000 Hrs		
AINB1C3 L70 Lumen Maintenance @ 25°C / 77°F	20	1.00	0.93	0.86	0.72	106,000	
AINB2C3 L70 Lumen Maintenance @ 25°C / 77°F	20	1.00	0.93	0.86	0.72	106,000	
TM-21-11	Input Watts	Initial	25,000 Hrs	50,000 Hrs	100,000 Hrs	Calculated L70@ 50°C	
AINB1C3 L70 Lumen Maintenance @ 50°C / 122°F	20	1.00	0.91	0.83	0.66	88,000	
AINB2C3 L70 Lumen Maintenance @ 50°C / 122°F	20	1.00	0.91	0.83	0.66	88,000	
TM-21-11	Input Watts	Initial	25,000 Hrs	50,000 Hrs	100,000 Hrs	Calculated L80@ 40°C	
AINB1C3 L80 Lumen Maintenance @ 40°C / 104°F	20	1.00	0.92	0.84	0.67	61,000	
AINB2C3 L80 Lumen Maintenance @ 40°C / 104°F	20	1.00	0.92	0.84	0.67	61,000	

NOTES:

1. Projected per IESNA TM-21-11. Data references the extrapolated performance projections for the 350mA base model in a 25°C ambient, based on 10,000 hours of LED testing per IESNA LM-80-08.
2. Compare to MH box indicates suggested Light Loss Factor (LLF) to be used when comparing to Metal Halide (MH) systems.

Specifications subject to change without notice. Rev. 082919