

# AIRWA926

## Roadway Arms



AIRWA926 without Scroll



AIRWA926 with Scroll

48" Single Arm EPA: 1.5  
48" Double Arm EPA: 2.9

Weight Load Per Arm: 70 lbs.

### Specifications and Features:

#### Specifications

Arms Are Constructed of Cast Aluminum and Are Available in 48", 72" or 96".

#### Mounting

Arms are Mounted Directly to the Pole Using Hex Head Bolts and Washers. Poles Provided by Atlantic Lighting Will be Machined with Heavy Duty Threaded Nutserts Installed by the Factory Before Finish.

#### Requirements

Decorative Luminaire Mounting Device (Ordered Separately on the Last Page) is Required For This Arm. This Device is Used for Pendant Mounted Fixtures Only. Horizontally Mounted Fixtures Fit Directly to a 2 3/8" Slipfitter.

#### Arm Orientation

Standard Double Arm Orientation is 180°. For Custom Orientation, Please Contact the Factory.

#### Finish

Super Durable Polyester Powder Coat Finish. Custom Finishes Available, Including Patinas and All RAL Colors.

#### Warranty

5 Year Limited Warranty

**Order Information Example:** AIRWA926SGPM48PENSCRBK

AIRWA926		PM				
	# of Arms	Arm Mount	Arm Length	Fixture Mount	Options	Finish
	SG=Single DB=Double	PM=Post/Pole Mount	48=48" 72=72" 96=96"	TEN=Horizontal Tenon Mount PEN=Pendant Mount*  *Must Order Separate Mounting Device (Last Page)	N=None SCR=Scroll	<b>STANDARD FINISHES</b> BK=Black BZ=Bronze DBZ=Dark Bronze WH=White GR=Green SM=Silver Metallic GY=Light Gray TBK=Textured Black* CC=Custom Color (Consult Factory)  *Matches Atlantic B-Black Finish

#### Project Information:

Project Name: \_\_\_\_\_ Fixture Type: \_\_\_\_\_

Complete Catalog #: \_\_\_\_\_ Date: \_\_\_\_\_

Comments: \_\_\_\_\_

#### Certification & Listings:

Specifications subject to change without notice. Rev. 021022

**Dimensions**

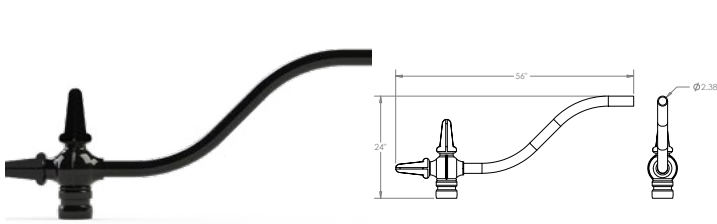

**AIRWA926SG48 without Scroll**

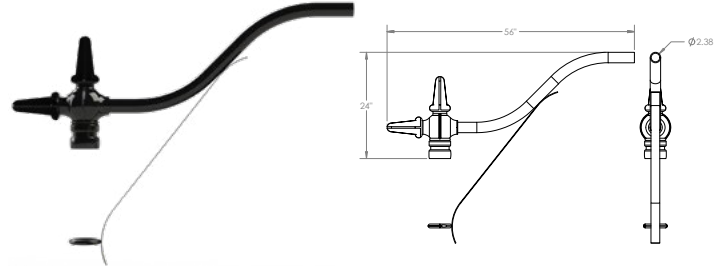

**AIRWA926SG48 with Scroll**

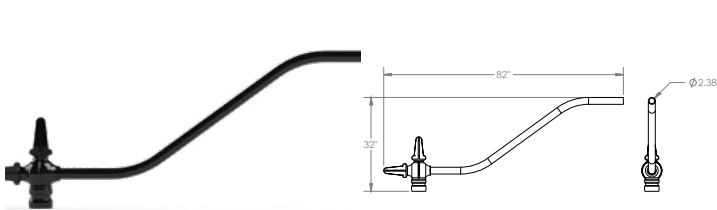

**AIRWA926SG72 without Scroll**

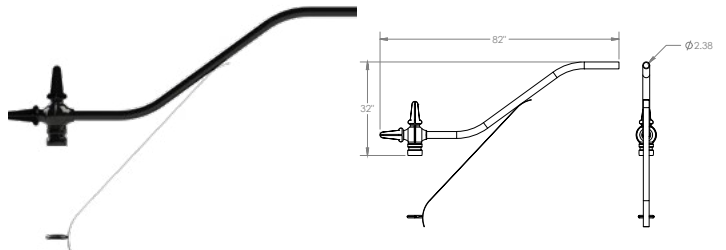

**AIRWA926SG72 with Scroll**

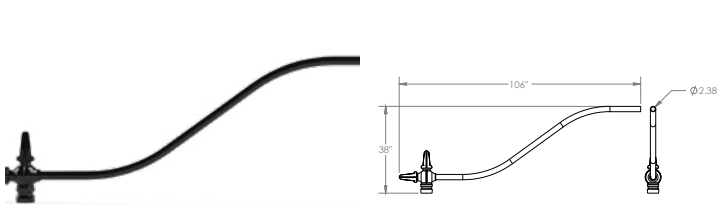

**AIRWA926SG96 without Scroll**

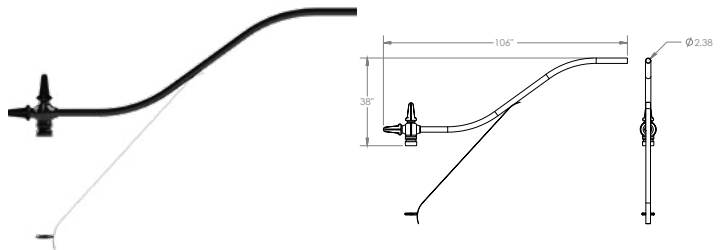

**AIRWA926SG96 with Scroll**

**Dimensions**

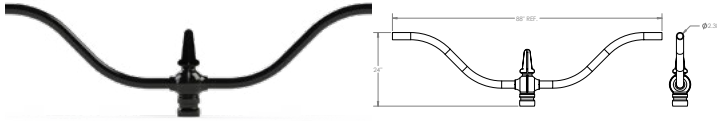

**AIRWA926DB48 without Scroll**

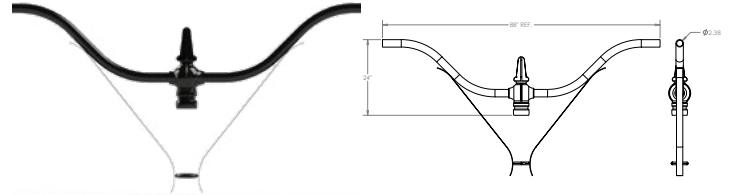

**AIRWA926DB48 with Scroll**

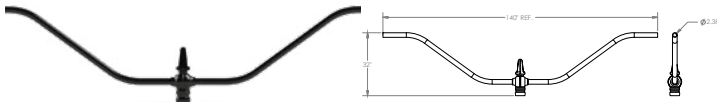

**AIRWA926DB72 without Scroll**

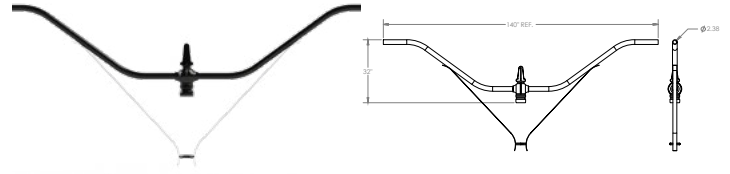

**AIRWA926DB72 with Scroll**

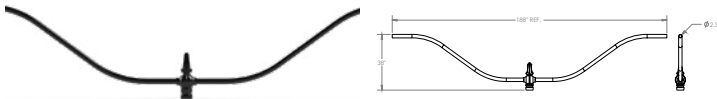

**AIRWA926DB96 without Scroll**

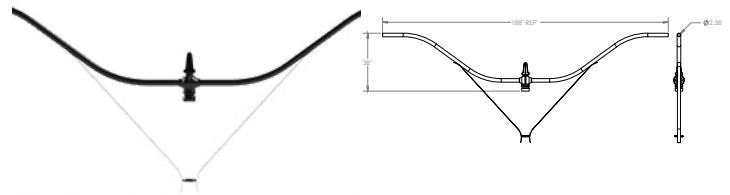

**AIRWA926DB96 with Scroll**

# AIRWM

## Decorative Luminaire Mounting Device



**AIRWM002RD**

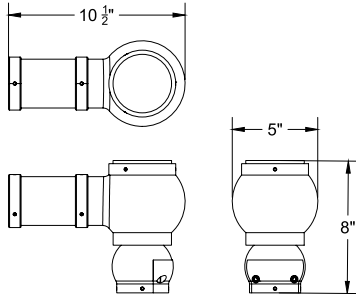

### Specifications and Features:

#### Specifications

All Mounting Devices Fit 2<sup>3</sup>/<sub>8</sub>" Horizontal Oriented Arms Attached with Six 1<sup>1</sup>/<sub>4</sub>"-20 Set Screws. Mounting Devices (Knuckles) Are Used as Levelers for Pendant Mounted Luminaires.

#### Options (for AIRWM001 & AIRWM002 Only)

- 3-Pin Twist-Lock Receptacle (PCR3). Sensor by Others.
- 7-Pin Twist-Lock Receptacle (PCR7). Sensor by Others.
- Finial



**AIRWM001SQ**

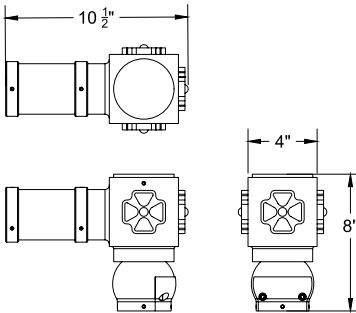

**AIRWM001SQ**  
Shown with Optional  
BA Finial (Adder)

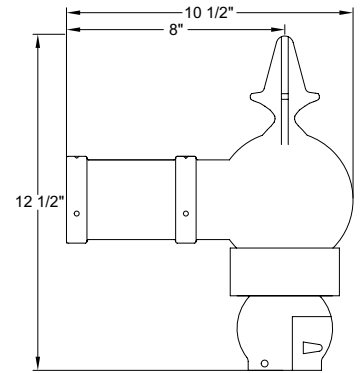

**AIRWM003-CF**

### Order Information Example:

**AIRWMA001SQNNBK**

Models	Finial	Options	Finish
<b>AIRWM001SQ</b> =Square <b>AIRWM002RD</b> =Round <b>AIRWM003CF</b> =Round Casting with Integrated Finial	<b>N</b> =None <b>BA</b> =Ball Finial* <b>AC</b> =Acorn Finial* *AIRWM001 & AIRWM002 Only	<b>N</b> =None <b>PCR3</b> =3-Pin Twist-Lock Receptacle* <b>PCR7</b> =7-Pin Twist-Lock Receptacle* *AIRWM001 & AIRWM002 Only Photozell Not Included.	<b>STANDARD FINISHES</b> <b>BK</b> =Black <b>BZ</b> =Bronze <b>DBZ</b> =Dark Bronze <b>WH</b> =White <b>GR</b> =Green <b>SM</b> =Silver Metallic <b>GY</b> =Light Gray <b>TBK</b> =Textured Black* <b>CC</b> =Custom Color (Consult Factory) *Matches Atlantic B-Black Finish

### Project Information:

Project Name: \_\_\_\_\_ Fixture Type: \_\_\_\_\_

Complete Catalog #: \_\_\_\_\_ Date: \_\_\_\_\_

Comments: \_\_\_\_\_

### Certification & Listings: